



2018 EASTERN ANALYTICAL SYMPOSIUM & EXPOSITION

[An IRS 501(c)(3) Non-Profit Educational Organization Managed by Volunteer Scientists]

Crowne Plaza Princeton - Conference Center, Plainsboro Township, NJ

November 12 - 14, 2018 Monday-Wednesday

EXPOSITION HOURS: 9 am - 4 pm Monday, Wednesday, Tuesday 9 am - 5:30 pm



APPLICATION for EXHIBIT SPACE

SPACE RENTAL

Booths are 8' x 10'

Booths\$ 3,000.

Booths are carpeted, but do not include furniture.

Tabletops are 6' long

Tabletops\$ 2,000.

Tabletops are carpeted, and include a draped table and two chairs.

SUN	MON	TUES	WED	THUR
11	12	13	14	15
SETUP 8-7	9 - 4	9 - 5:30	9-4 4-11 Dismantle	
	←	S H O W	→	

Payment Policy - Payment Policy - When your Application for Exhibit Space is received, you will be e-mailed an invoice. **Payment of at least 50 percent of Space Rental Fee must be received within 14 days of your receipt of the invoice, unless alternate arrangements have been made with the Exposition Director.** Unpaid balance, if any, is due by May 1, 2018. After June 1, 2018, Full Rental Fee must be received within 14 days of your receipt of the invoice.

Refund Policy - You may receive a refund of 50% of what you have paid for your booth rental if cancellation in writing is received by May 1, 2018; 25% if received by June 1, 2018. No Refund if cancellation is received after June 1, 2018.

Join us at EAS in 2018 as we focus on Green Analytical Solutions to the World's Problems. In 2018, we will remain in our new venue, the Crowne Plaza Princeton - Conference Center in Plainsboro, NJ. This modern facility, located close to a large concentration of analytical chemists and scientists, allows us to hold the exposition, technical program, and short courses all under one roof. Based on feedback received at the 2017 meeting, the exposition will be located in the Wilson Room, Madison Room, and Lakeside Terrace all on the first floor, as well as Waterfront I and II and Bridgeview, located on the lower level.

EAS remains committed to analytical chemists and those in the allied sciences in the Northeastern United States. We are very excited about our new venue, which permits our vendors to display the latest in analytical instrumentation, supplies, and services in a beautiful modern facility.

Your 8' by 10' booth or 6' tabletop display includes four exhibitor registrations for your personnel, invited customer vouchers to allow your customers to attend the exposition at a reduced cost, and free access to the pre-registrants' list and attendees' list.

2018 EAS BOOTH SELECTION PROTOCOL

Please refer to floor plan on reverse side.

Exhibitors are limited to one booth or one tabletop. From December 11, 2017 to January 1, 2018 companies that exhibited with us in 2017 have the opportunity to reserve their space for the 2018 show. After January 1, 2018 any remaining booths or tabletops will be available to any exhibitor wishing to rent space at the show.

Please indicate whether you wish to reserve:

- 8' by 10' booth (does not include furniture)
- 6' tabletop (includes white draped table and two chairs)

Preferred room:

- Madison (booths and tabletops)
- Wilson (booths and tabletops)
- Lakeside Terrace (booths only)
- Waterfront I and II (booths and tabletops)
- Bridgeview (tabletops only)

I would also like to reserve an instrument demo room/seminar room for the 2018 EAS.

Please print legibly and e-mail or mail this completed form to Sheree Gold.

Authorized by _____ Signature _____

Title _____ e-mail: _____

Company Name _____ website: _____

Address _____ City _____ State _____ Zip _____

Phone No. _____ Ext. _____ FAX No. _____

Name and e-mail for the person who will be coordinating your booth: _____

Sheree Gold
 EAS Exposition Director
 P.O. Box 633
 Montchanin, DE 19710-0633
 USA

Phone: 1-302-478-2129
 Cell: 1-610-742-4981
 e-mail: easinfo@aol.com

FOR OFFICE USE ONLY

EXPOSITION FLOOR PLAN

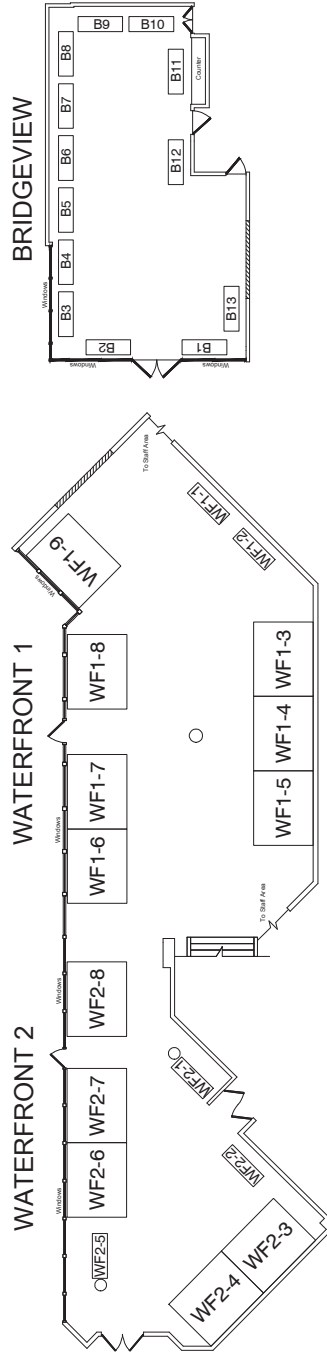
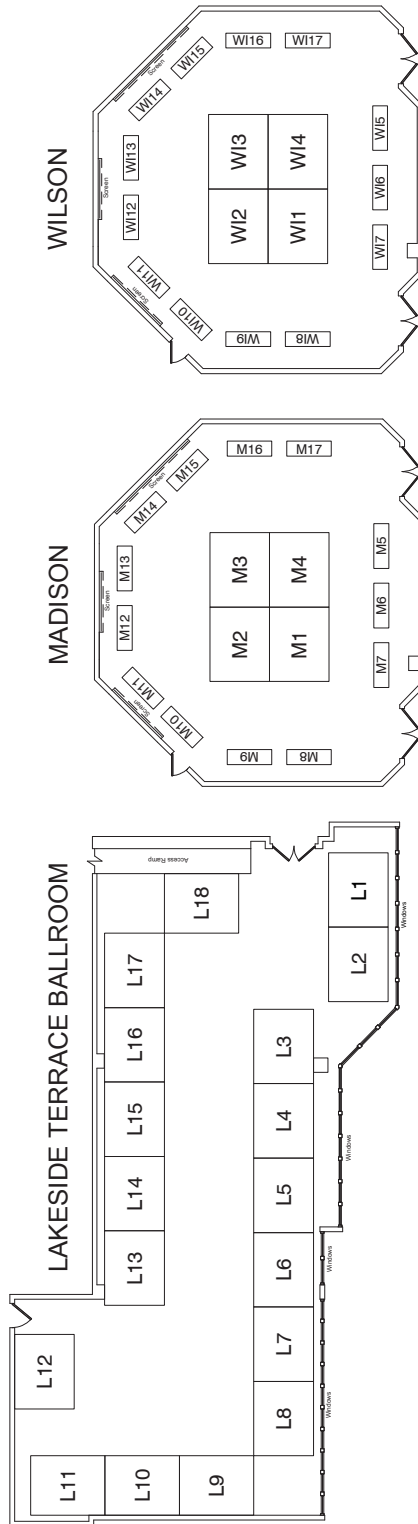

2018 EASTERN ANALYTICAL SYMPOSIUM & EXPOSITION
 [An IRS 501(c)(3) Non-Profit Educational Organization Managed by Volunteer Scientists]
Crowne Plaza Princeton - Conference Center, Plainsboro Township, NJ
November 12 - 14, 2018 Monday-Wednesday
EXPOSITION HOURS: 9 am - 4 pm Monday, Wednesday, Tuesday 9 am - 5:30 pm

